



## PK SERIES

PEAKING COILS.

### Applications:

- TVs and Audio equipment.
- Telecommunication devices.
- Personal computer.
- Switching Power Supply.
- Other noise filter.



### Shape and Dimensions(Dimensions are in mm) :

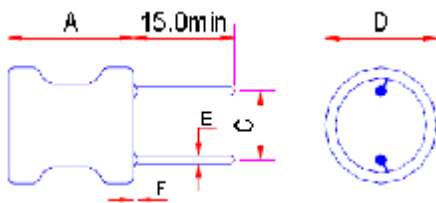

| Item   | A Max. | C       | D Max. | E±0.05 | Item   | A Max. | C        | D Max. | E±0.05 |
|--------|--------|---------|--------|--------|--------|--------|----------|--------|--------|
| PK0406 | 8.0    | 2.0±0.5 | 5.5    | 0.55   | PK1010 | 13.0   | 5.0+1.0  | 12.0   | 0.80   |
| PK0608 | 11.0   | 2.5±0.5 | 7.5    | 0.65   | PK1012 | 15.0   | 6.0+1.0  | 12.0   | 0.80   |
| PK0707 | 9.5    | 5.0±1.0 | 8.5    | 0.65   | PK1018 | 21.0   | 6.0±1.0  | 12.0   | 0.80   |
| PK0807 | 9.5    | 5.0±1.0 | 10.0   | 0.55   | PK1213 | 16.0   | 7.50±1.0 | 14.0   | 0.80   |
| PK0810 | 13.0   | 5.0+1.0 | 10.0   | 0.65   |        |        |          |        |        |

### Features :

- Low cost.
- Wide range of inductance.
- Small mounting space required.
- 0406 type with excellent characteristics for high Q.
- The other types with low DCR, high current, best for the power supply line.
- Tape packaging for auto-insertion.

### Characteristics :

- Rated Current : It is either the inductance is 10% lower is than its initial value in DC. saturation characteristics or temperature rise becomes  $\Delta T=20^{\circ}\text{C}$  ( $T_a=20$ ) Whichever lower.
- Operating temperature :  $-20$  to  $85^{\circ}\text{C}$ .

### Product Identification :

#### PK 0608 – 503 K – UL – TF

(1) (2) (3) (4) (5) (6)

- (1) Type: **Peaking coils.**
- (2) Style : Core size, **OD=6 mm , L=8 mm.**
- (3) Inductance: **“503”** for **50 mH.**
- (4) Tolerance: **“J”**:  $\pm 5\%$ ; **“K”**:  $\pm 10\%$ ; **“M”**:  $\pm 20\%$ .
- (5) Sleeve: UL tube, Black,  $125^{\circ}\text{C}$ ; No code: NO sleeve
- (6) Taping Mode: **TF** Taping; No code: bulk

### Test equipments :

- L&Q: HP 4285A or HP 4284A.
- DCR: Milli-ohm meter.
- SRF: HM 9461 L-SRF meter.
- Electrical specifications at  $25^{\circ}\text{C}$ .

**● PK0406 series**

| Part No.       | L<br>@1kHz<br>( uH ) | Q<br>Min. | Q<br>Test<br>Freq. | SRF<br>(MHz)<br>Min. | DCR<br>(Ω)<br>Max. | Rated<br>Current<br>(mA) Max. |
|----------------|----------------------|-----------|--------------------|----------------------|--------------------|-------------------------------|
| PK0406-1R0M-□□ | 1.0                  | 100       | 7.96MHz            | 120                  | 0.035              | 2000                          |
| PK0406-1R2M-□□ | 1.2                  | 100       | 7.96 MHz           | 120                  | 0.058              | 1950                          |
| PK0406-1R5M-□□ | 1.5                  | 100       | 7.96 MHz           | 120                  | 0.075              | 1900                          |
| PK0406-1R8M-□□ | 1.8                  | 100       | 7.96 MHz           | 120                  | 0.110              | 1800                          |
| PK0406-2R2M-□□ | 2.2                  | 100       | 7.96 MHz           | 100                  | 0.120              | 1750                          |
| PK0406-2R7M-□□ | 2.7                  | 100       | 7.96 MHz           | 80                   | 0.125              | 1680                          |
| PK0406-3R3M-□□ | 3.3                  | 100       | 7.96 MHz           | 75                   | 0.130              | 1500                          |
| PK0406-3R9K-□□ | 3.9                  | 100       | 7.96 MHz           | 70                   | 0.135              | 1450                          |
| PK0406-4R7K-□□ | 4.7                  | 100       | 7.96 MHz           | 50                   | 0.140              | 1320                          |
| PK0406-5R6K-□□ | 5.6                  | 100       | 7.96 MHz           | 45                   | 0.145              | 1230                          |
| PK0406-6R8K-□□ | 6.8                  | 100       | 7.96 MHz           | 30                   | 0.15               | 1150                          |
| PK0406-8R2K-□□ | 8.2                  | 100       | 7.96 MHz           | 22                   | 0.16               | 1100                          |
| PK0406-100K-□□ | 10                   | 80        | 2.52 MHz           | 20                   | 0.23               | 1000                          |
| PK0406-120K-□□ | 12                   | 80        | 2.52 MHz           | 17                   | 0.24               | 970                           |
| PK0406-150K-□□ | 15                   | 80        | 2.52 MHz           | 16                   | 0.25               | 920                           |
| PK0406-180K-□□ | 18                   | 80        | 2.52 MHz           | 12                   | 0.33               | 860                           |
| PK0406-220K-□□ | 22                   | 80        | 2.52 MHz           | 10                   | 0.45               | 800                           |
| PK0406-270K-□□ | 27                   | 80        | 2.52 MHz           | 9.5                  | 0.50               | 710                           |
| PK0406-330K-□□ | 33                   | 80        | 2.52 MHz           | 8.7                  | 0.70               | 660                           |
| PK0406-390K-□□ | 39                   | 70        | 2.52 MHz           | 8.2                  | 0.74               | 600                           |
| PK0406-470K-□□ | 47                   | 70        | 2.52 MHz           | 7.8                  | 0.76               | 550                           |
| PK0406-560K-□□ | 56                   | 50        | 2.52 MHz           | 7.6                  | 0.80               | 500                           |
| PK0406-680K-□□ | 68                   | 50        | 2.52 MHz           | 6.8                  | 0.90               | 470                           |
| PK0406-820K-□□ | 82                   | 50        | 2.52 MHz           | 6.0                  | 0.95               | 430                           |
| PK0406-101K-□□ | 100                  | 45        | 796kHz             | 6.0                  | 1.0                | 400                           |
| PK0406-121K-□□ | 120                  | 45        | 796kHz             | 5.5                  | 1.1                | 370                           |
| PK0406-151K-□□ | 150                  | 65        | 796kHz             | 4.2                  | 1.3                | 350                           |
| PK0406-181k-□□ | 180                  | 65        | 796kHz             | 3.6                  | 1.5                | 320                           |
| PK0406-221k-□□ | 220                  | 65        | 796kHz             | 2.8                  | 1.8                | 300                           |
| PK0406-271k-□□ | 270                  | 50        | 796kHz             | 2.4                  | 1.9                | 275                           |
| PK0406-331K-□□ | 330                  | 50        | 796kHz             | 2.2                  | 2.2                | 250                           |
| PK0406-391K-□□ | 390                  | 50        | 796kHz             | 2.0                  | 2.7                | 220                           |
| PK0406-471K-□□ | 470                  | 50        | 796kHz             | 1.7                  | 3.6                | 200                           |
| PK0406-561K-□□ | 560                  | 50        | 796kHz             | 1.5                  | 4.2                | 190                           |
| PK0406-681K-□□ | 680                  | 50        | 796kHz             | 1.3                  | 4.6                | 170                           |
| PK0406-821K-□□ | 820                  | 50        | 796kHz             | 1.1                  | 5.7                | 155                           |
| PK0406-102K-□□ | 1000                 | 90        | 252kHz             | 1.0                  | 6.7                | 150                           |
| PK0406-122K-□□ | 1200                 | 90        | 252kHz             | 0.9                  | 8.2                | 140                           |
| PK0406-152K-□□ | 1500                 | 80        | 252kHz             | 0.8                  | 13                 | 120                           |
| PK0406-182K-□□ | 1800                 | 80        | 252kHz             | 0.8                  | 15                 | 110                           |
| PK0406-222K-□□ | 2200                 | 80        | 252kHz             | 0.8                  | 17                 | 100                           |
| PK0406-272K-□□ | 2700                 | 80        | 252kHz             | 0.8                  | 19                 | 90                            |
| PK0406-332K-□□ | 3300                 | 70        | 252kHz             | 0.7                  | 26                 | 83                            |
| PK0406-392K-□□ | 3900                 | 70        | 252kHz             | 0.65                 | 30                 | 76                            |
| PK0406-472K-□□ | 4700                 | 65        | 252kHz             |                      | 45                 | 70                            |
| PK0406-562K-□□ | 5600                 | 65        | 252kHz             |                      | 48                 | 62                            |
| PK0406-682K-□□ | 6800                 | 65        | 252kHz             |                      | 56                 | 56                            |
| PK0406-822K-□□ | 8200                 | 65        | 252kHz             |                      | 62                 | 52                            |
| PK0406-103K-□□ | 10000                | 45        | 79.6kHz            |                      | 72                 | 47                            |
| PK0406-153K-□□ | 15000                | 45        | 79.6kHz            |                      | 120                | 35                            |
| PK0406-223K-□□ | 22000                | 45        | 79.6kHz            |                      | 160                | 24                            |
| PK0406-253K-□□ | 25000                | 45        | 79.6kHz            |                      | 180                | 20                            |

**I PK0608 series**

| Part No.       | L<br>@1kHz<br>( $\mu$ H) | Q<br>Min. | Q<br>Test<br>Freq. | DCR<br>( $\Omega$ )<br>Max. | Rated<br>Current<br>(mA) Max. |
|----------------|--------------------------|-----------|--------------------|-----------------------------|-------------------------------|
| PK0608-3R3K-□□ | 3.3                      | 20        | 7.96MHz            | 0.016                       | 3500                          |
| PK0608-4R7K-□□ | 4.7                      | 20        | 7.96MHz            | 0.020                       | 3000                          |
| PK0608-6R8K-□□ | 6.8                      | 20        | 7.96MHz            | 0.022                       | 2500                          |
| PK0608-100K-□□ | 10                       | 30        | 2.52MHz            | 0.039                       | 2000                          |
| PK0608-150K-□□ | 15                       | 30        | 2.52MHz            | 0.045                       | 1700                          |
| PK0608-220K-□□ | 22                       | 30        | 2.52MHz            | 0.062                       | 1400                          |
| PK0608-330K-□□ | 33                       | 30        | 2.52MHz            | 0.10                        | 1100                          |
| PK0608-470K-□□ | 47                       | 30        | 2.52MHz            | 0.15                        | 950                           |
| PK0608-680K-□□ | 68                       | 30        | 2.52MHz            | 0.22                        | 800                           |
| PK0608-101K-□□ | 100                      | 20        | 796kHz             | 0.35                        | 650                           |
| PK0608-151K-□□ | 150                      | 20        | 796kHz             | 0.43                        | 540                           |
| PK0608-221K-□□ | 220                      | 20        | 796kHz             | 0.90                        | 440                           |
| PK0608-331K-□□ | 330                      | 20        | 796kHz             | 1.50                        | 360                           |
| PK0608-471K-□□ | 470                      | 20        | 796kHz             | 1.80                        | 300                           |
| PK0608-681K-□□ | 680                      | 20        | 796kHz             | 2.50                        | 250                           |
| PK0608-102K-□□ | 1000                     | 100       | 252kHz             | 3.20                        | 200                           |
| PK0608-122K-□□ | 1200                     | 70        | 252kHz             | 3.5                         | 180                           |
| PK0608-152K-□□ | 1500                     | 70        | 252kHz             | 4.5                         | 170                           |
| PK0608-182K-□□ | 1800                     | 70        | 252kHz             | 5.0                         | 155                           |
| PK0608-222K-□□ | 2200                     | 70        | 252kHz             | 6.8                         | 140                           |
| PK0608-272K-□□ | 2700                     | 70        | 252kHz             | 7.2                         | 125                           |
| PK0608-332K-□□ | 3300                     | 70        | 252kHz             | 10.5                        | 115                           |
| PK0608-392K-□□ | 3900                     | 70        | 252kHz             | 11.7                        | 105                           |
| PK0608-472K-□□ | 4700                     | 70        | 252kHz             | 13.6                        | 95                            |
| PK0608-562K-□□ | 5600                     | 70        | 252kHz             | 16.6                        | 85                            |
| PK0608-682K-□□ | 6800                     | 70        | 252kHz             | 19.6                        | 80                            |
| PK0608-822K-□□ | 8200                     | 70        | 252kHz             | 25.2                        | 70                            |
| PK0608-103K-□□ | 10000                    | 70        | 79.6kHz            | 29.5                        | 65                            |
| PK0608-123K-□□ | 12000                    | 50        | 79.6kHz            | 33.8                        | 60                            |
| PK0608-153K-□□ | 15000                    | 50        | 79.6kHz            | 45.4                        | 55                            |
| PK0608-183K-□□ | 18000                    | 50        | 79.6kHz            | 50.4                        | 50                            |
| PK0608-223K-□□ | 22000                    | 50        | 79.6kHz            | 80.0                        | 45                            |
| PK0608-303K-□□ | 30000                    | 50        | 79.6kHz            | 91.5                        | 40                            |
| PK0608-333K-□□ | 33000                    | 50        | 79.6kHz            | 98.5                        | 35                            |
| PK0608-393K-□□ | 39000                    | 50        | 79.6kHz            | 140                         | 32                            |
| PK0608-473K-□□ | 47000                    | 50        | 79.6kHz            | 160                         | 30                            |
| PK0608-503K-□□ | 50000                    | 50        | 79.6kHz            | 170                         | 29                            |
| PK0608-563K-□□ | 56000                    | 50        | 79.6kHz            | 250                         | 28                            |
| PK0608-683K-□□ | 68000                    | 50        | 79.6kHz            | 282                         | 25                            |
| PK0608-823K-□□ | 82000                    | 50        | 79.6kHz            | 312                         | 23                            |
| PK0608-104K-□□ | 100000                   | 30        | 25.2kHz            | 380                         | 20                            |
| PK0608-124K-□□ | 120000                   | 30        | 25.2kHz            | 430                         | 18                            |
| PK0608-154K-□□ | 150000                   | 30        | 25.2kHz            | 520                         | 16                            |

**I PK0707 / 0807 series**

| Part No.       | L<br>@1kHz<br>(uH) | Q<br>Min. | Q<br>Test<br>Freq. | SRF<br>(MHz)<br>Min. | DCR<br>(Ω)<br>Max. | Saturation<br>Current<br>(A)Max. | Temperature<br>Rise Current<br>(A)Max. |
|----------------|--------------------|-----------|--------------------|----------------------|--------------------|----------------------------------|--|
| PK0707-1R0M-□□ | 1.0                | 10        | 7.96MHz            | 70                   | 0.006              | 6.6                              | 5.0                                    |
| PK0707-1R5M-□□ | 1.5                | 10        | 7.96MHz            | 56                   | 0.008              | 5.4                              | 4.3                                    |
| PK0707-2R2M-□□ | 2.2                | 10        | 7.96MHz            | 45                   | 0.011              | 4.0                              | 3.7                                    |
| PK0707-3R3M-□□ | 3.3                | 10        | 7.96MHz            | 36                   | 0.018              | 3.6                              | 2.9                                    |
| PK0707-4R7M-□□ | 4.7                | 10        | 7.96MHz            | 29                   | 0.022              | 3.1                              | 2.6                                    |
| PK0707-6R8M-□□ | 6.8                | 10        | 7.96MHz            | 24                   | 0.028              | 2.5                              | 2.3                                    |
| PK0707-100K-□□ | 10                 | 20        | 2.52MHz            | 19                   | 0.043              | 2.1                              | 1.9                                    |
| PK0707-150K-□□ | 15                 | 20        | 2.52MHz            | 15                   | 0.056              | 1.7                              | 1.6                                    |
| PK0707-220K-□□ | 22                 | 20        | 2.52MHz            | 12                   | 0.086              | 1.4                              | 1.3                                    |
| PK0707-330K-□□ | 33                 | 20        | 2.52MHz            | 9.4                  | 0.14               | 1.1                              | 1.0                                    |
| PK0707-470K-□□ | 47                 | 20        | 2.52MHz            | 7.6                  | 0.17               | 0.96                             | 0.94                                   |
| PK0707-680K-□□ | 68                 | 20        | 2.52MHz            | 6.2                  | 0.28               | 0.79                             | 0.73                                   |
| PK0707-101K-□□ | 100                | 20        | 796KHz             | 5.0                  | 0.33               | 0.66                             | 0.67                                   |
| PK0707-151K-□□ | 150                | 20        | 796KHz             | 4.0                  | 0.56               | 0.53                             | 0.52                                   |
| PK0707-221K-□□ | 220                | 20        | 796KHz             | 3.2                  | 0.72               | 0.44                             | 0.46                                   |
| PK0707-331K-□□ | 330                | 20        | 796KHz             | 2.5                  | 1.10               | 0.36                             | 0.37                                   |
| PK0707-471K-□□ | 470                | 20        | 796KHz             | 2.0                  | 1.70               | 0.30                             | 0.30                                   |
| PK0707-681K-□□ | 680                | 20        | 796KHz             | 1.7                  | 2.30               | 0.25                             | 0.26                                   |
| PK0707-102K-□□ | 1000               | 70        | 252KHz             | 1.3                  | 4.30               | 0.20                             | 0.19                                   |
| PK0707-152K-□□ | 1500               | 50        | 252KHz             | 1.3                  | 5.00               | 0.17                             | 0.16                                   |
| PK0807-2R2M-□□ | 2.2                | 10        | 7.96MHz            | 60                   | 0.011              | 0.55                             | 4.0                                    |
| PK0807-3R3M-□□ | 3.3                | 10        | 7.96MHz            | 38                   | 0.013              | 3.8                              | 3.4                                    |
| PK0807-4R7M-□□ | 4.7                | 10        | 7.96MHz            | 30                   | 0.017              | 3.7                              | 3.0                                    |
| PK0807-6R8M-□□ | 6.8                | 10        | 7.96MHz            | 24                   | 0.023              | 2.8                              | 2.6                                    |
| PK0807-100K-□□ | 10                 | 20        | 2.52MHz            | 19                   | 0.031              | 2.5                              | 2.2                                    |
| PK0807-150K-□□ | 15                 | 20        | 2.52MHz            | 15                   | 0.042              | 2.0                              | 1.9                                    |
| PK0807-220K-□□ | 22                 | 20        | 2.52MHz            | 12                   | 0.070              | 1.6                              | 1.5                                    |
| PK0807-330K-□□ | 33                 | 20        | 2.52MHz            | 10                   | 0.092              | 1.3                              | 1.2                                    |
| PK0807-470K-□□ | 47                 | 20        | 2.52MHz            | 8.2                  | 0.130              | 1.1                              | 1.0                                    |
| PK0807-680K-□□ | 68                 | 20        | 2.52MHz            | 6.6                  | 0.160              | 0.91                             | 0.97                                   |
| PK0807-101K-□□ | 100                | 15        | 796KHz             | 5.4                  | 0.230              | 0.75                             | 0.81                                   |
| PK0807-151K-□□ | 150                | 15        | 796KHz             | 4.3                  | 0.400              | 0.61                             | 0.61                                   |
| PK0807-221K-□□ | 220                | 15        | 796KHz             | 3.5                  | 0.530              | 0.50                             | 0.53                                   |
| PK0807-331K-□□ | 330                | 15        | 796KHz             | 2.8                  | 0.780              | 0.41                             | 0.44                                   |
| PK0807-471K-□□ | 470                | 10        | 796KHz             | 2.3                  | 1.0                | 0.34                             | 0.39                                   |
| PK0807-681K-□□ | 680                | 10        | 796KHz             | 1.9                  | 1.5                | 0.28                             | 0.32                                   |
| PK0807-102K-□□ | 1000               | 20        | 252KHz             | 1.5                  | 2.2                | 0.23                             | 0.26                                   |
| PK0807-152K-□□ | 1500               | 30        | 252KHz             | 1.2                  | 3.5                | 0.18                             | 0.21                                   |

NOTE: Saturation Current(Isat) : the value of inductance decrease within 10%.

Temperature Rise Current(Irms) : Temperature rise of core surface within 20°C.

**PK0810 TYPE**

| Part No.       | L<br>@1kHz<br>(uH) | Q<br>Min. | L / Q<br>Test<br>Freq. | SRF<br>(MHz)<br>Min. | DCR<br>(Ω)<br>Max. | Rated<br>Current<br>(mA) Max. |
|----------------|--------------------|-----------|------------------------|----------------------|--------------------|-------------------------------|
| PK0810-3R3M-□□ | 3.3                | 30        | 7.96MHz                | 65                   | 0.012              | 5000                          |
| PK0810-3R9K-□□ | 3.9                | 30        | 7.96MHz                | 55                   | 0.014              | 4600                          |
| PK0810-4R7K-□□ | 4.7                | 30        | 7.96MHz                | 45                   | 0.016              | 4300                          |
| PK0810-5R6K-□□ | 5.6                | 30        | 7.96MHz                | 38                   | 0.020              | 3900                          |
| PK0810-6R8K-□□ | 6.8                | 30        | 7.96MHz                | 27                   | 0.022              | 3700                          |
| PK0810-8R2K-□□ | 8.2                | 30        | 7.96MHz                | 21                   | 0.024              | 3500                          |
| PK0810-100K-□□ | 10                 | 50        | 2.52MHz                | 17                   | 0.025              | 3200                          |
| PK0810-120K-□□ | 12                 | 50        | 2.52MHz                | 15                   | 0.027              | 3000                          |
| PK0810-150K-□□ | 15                 | 50        | 2.52MHz                | 13                   | 0.033              | 2800                          |
| PK0810-180K-□□ | 18                 | 50        | 2.52MHz                | 12                   | 0.039              | 2600                          |
| PK0810-220K-□□ | 22                 | 50        | 2.52MHz                | 11                   | 0.047              | 2400                          |
| PK0810-270K-□□ | 27                 | 50        | 2.52MHz                | 10                   | 0.052              | 2100                          |
| PK0810-330K-□□ | 33                 | 50        | 2.52MHz                | 8.5                  | 0.075              | 1900                          |
| PK0810-390K-□□ | 39                 | 40        | 2.52MHz                | 7.7                  | 0.082              | 1700                          |
| PK0810-470K-□□ | 47                 | 40        | 2.52MHz                | 6.7                  | 0.10               | 1500                          |
| PK0810-560K-□□ | 56                 | 40        | 2.52MHz                | 6.4                  | 0.15               | 1300                          |
| PK0810-680K-□□ | 68                 | 30        | 2.52MHz                | 5.8                  | 0.18               | 1200                          |
| PK0810-820K-□□ | 82                 | 30        | 2.52MHz                | 5.2                  | 0.20               | 1100                          |
| PK0810-101K-□□ | 100                | 30        | 796kHz                 | 4.4                  | 0.20               | 900                           |
| PK0810-121K-□□ | 120                | 30        | 796kHz                 | 4.2                  | 0.22               | 800                           |
| PK0810-151K-□□ | 150                | 30        | 796kHz                 | 3.7                  | 0.24               | 7200                          |
| PK0810-181K-□□ | 180                | 30        | 796kHz                 | 3.5                  | 0.28               | 6500                          |
| PK0810-221K-□□ | 220                | 20        | 796kHz                 | 3.3                  | 0.35               | 600                           |
| PK0810-271K-□□ | 270                | 20        | 796kHz                 | 2.9                  | 0.40               | 550                           |
| PK0810-331K-□□ | 330                | 20        | 796kHz                 | 2.6                  | 0.47               | 500                           |
| PK0810-391K-□□ | 390                | 20        | 796kHz                 | 2.4                  | 0.68               | 460                           |
| PK0810-471K-□□ | 470                | 20        | 796kHz                 | 2.2                  | 0.80               | 420                           |
| PK0810-561K-□□ | 560                | 20        | 796kHz                 | 2.0                  | 1.0                | 380                           |
| PK0810-681K-□□ | 680                | 20        | 796kHz                 | 1.8                  | 1.2                | 350                           |
| PK0810-821K-□□ | 820                | 20        | 796kHz                 | 1.7                  | 1.5                | 310                           |
| PK0810-102K-□□ | 1000               | 40        | 252kHz                 | 1.5                  | 1.8                | 280                           |
| PK0810-122K-□□ | 1200               | 40        | 252kHz                 | 1.4                  | 2.0                | 250                           |
| PK0810-152K-□□ | 1500               | 40        | 252kHz                 | 1.3                  | 2.4                | 230                           |
| PK0810-182K-□□ | 1800               | 40        | 252kHz                 | 1.1                  | 2.8                | 210                           |
| PK0810-222K-□□ | 2200               | 40        | 252kHz                 | 1.0                  | 3.3                | 190                           |
| PK0810-272K-□□ | 2700               | 40        | 252kHz                 | 0.88                 | 5.0                | 170                           |
| PK0810-332K-□□ | 3300               | 40        | 252kHz                 | 0.78                 | 5.6                | 150                           |
| PK0810-392K-□□ | 3900               | 40        | 252kHz                 | 0.72                 | 6.2                | 140                           |
| PK0810-472K-□□ | 4700               | 40        | 252kHz                 | 0.65                 | 7.0                | 130                           |
| PK0810-562K-□□ | 5600               | 40        | 252kHz                 | 0.58                 | 9.1                | 120                           |
| PK0810-682K-□□ | 6800               | 40        | 252kHz                 | 0.55                 | 10                 | 110                           |
| PK0810-822K-□□ | 8200               | 20        | 252kHz                 | 0.50                 | 15                 | 100                           |
| PK0810-103K-□□ | 10000              | 20        | 79.6kHz                | 0.42                 | 24                 | 90                            |
| PK0810-473K-□□ | 47000              | 60        | 79.6kHz                | 0.20                 | 80                 | 40                            |
| PK0810-104K-□□ | 100000             | 20        | 79.6kHz                | 0.14                 | 180                | 28                            |

**I PK1010 / 1012 series**

| Part No.       | L<br>@1kHz<br>( $\mu$ H) | Q<br>Min. | L / Q<br>Test<br>Freq. | SRF<br>(MHz)<br>Min. | DCR<br>( $\Omega$ )<br>Max. | Saturation<br>Current<br>(A)Max. | Temperature<br>Rise Current<br>(A)Max. |
|----------------|--------------------------|-----------|------------------------|----------------------|-----------------------------|----------------------------------|--|
| PK1010-3R3M-□□ | 3.3                      | 10        | 7.96MHz                | 36                   | 0.010                       | 8.8                              | 5.9                                    |
| PK1010-4R7M-□□ | 4.7                      | 10        | 7.96MHz                | 28                   | 0.015                       | 7.2                              | 4.8                                    |
| PK1010-6R8M-□□ | 6.8                      | 10        | 7.96MHz                | 18                   | 0.016                       | 6.1                              | 4.6                                    |
| PK1010-100M-□□ | 10                       | 20        | 2.52MHz                | 16                   | 0.025                       | 5.0                              | 3.7                                    |
| PK1010-150M-□□ | 15                       | 20        | 2.52MHz                | 12                   | 0.029                       | 4.2                              | 3.4                                    |
| PK1010-220K-□□ | 22                       | 20        | 2.52MHz                | 9.5                  | 0.040                       | 3.4                              | 2.9                                    |
| PK1010-330K-□□ | 33                       | 30        | 2.52MHz                | 7.0                  | 0.062                       | 2.8                              | 2.3                                    |
| PK1010-470K-□□ | 47                       | 30        | 2.52MHz                | 5.8                  | 0.075                       | 2.3                              | 2.1                                    |
| PK1010-680K-□□ | 68                       | 20        | 2.52MHz                | 4.7                  | 0.13                        | 1.9                              | 1.6                                    |
| PK1010-101K-□□ | 100                      | 20        | 796kHz                 | 3.8                  | 0.16                        | 1.6                              | 1.4                                    |
| PK1010-151K-□□ | 150                      | 20        | 796kHz                 | 3.1                  | 0.26                        | 1.3                              | 1.1                                    |
| PK1010-221K-□□ | 220                      | 20        | 796kHz                 | 2.5                  | 0.33                        | 1.1                              | 1.0                                    |
| PK1010-331K-□□ | 330                      | 20        | 796kHz                 | 2.0                  | 0.52                        | 0.88                             | 0.82                                   |
| PK1010-471K-□□ | 470                      | 10        | 796kHz                 | 1.6                  | 0.66                        | 0.75                             | 0.72                                   |
| PK1010-681K-□□ | 680                      | 10        | 796kHz                 | 1.3                  | 1.1                         | 0.61                             | 0.56                                   |
| PK1010-102K-□□ | 1000                     | 20        | 252kHz                 | 1.1                  | 1.4                         | 0.51                             | 0.50                                   |
| PK1010-152K-□□ | 1500                     | 30        | 252kHz                 | 0.82                 | 2.4                         | 0.43                             | 0.38                                   |
| PK1010-222K-□□ | 2200                     | 20        | 252kHz                 | 0.76                 | 3.2                         | 0.35                             | 0.33                                   |
| PK1010-332K-□□ | 3300                     | 30        | 252kHz                 | 0.64                 | 4.9                         | 0.28                             | 0.26                                   |
| PK1010-472K-□□ | 4700                     | 30        | 252kHz                 | 0.54                 | 7.6                         | 0.24                             | 0.21                                   |
| PK1010-682K-□□ | 6800                     | 30        | 252kHz                 | 0.45                 | 9.8                         | 0.20                             | 0.18                                   |
| PK1010-103K-□□ | 10000                    | 30        | 79.6kHz                | 0.38                 | 18                          | 0.17                             | 0.14                                   |
| PK1010-153K-□□ | 15000                    | 50        | 79.6kHz                | 0.29                 | 24                          | 0.13                             | 0.12                                   |
| PK1012-103K-□□ | 10000                    | 100       | 79.6kHz                | 0.35                 | 12                          | 0.18                             | 0.17                                   |
| PK1012-123K-□□ | 12000                    | 100       | 79.6kHz                | 0.31                 | 13                          | 0.16                             | 0.16                                   |
| PK1012-153K-□□ | 15000                    | 100       | 79.6kHz                | 0.28                 | 18                          | 0.14                             | 0.14                                   |
| PK1012-183K-□□ | 18000                    | 80        | 79.6kHz                | 0.26                 | 25                          | 0.13                             | 0.12                                   |
| PK1012-223K-□□ | 22000                    | 80        | 79.6kHz                | 0.22                 | 30                          | 0.12                             | 0.11                                   |
| PK1012-273K-□□ | 27000                    | 80        | 79.6kHz                | 0.20                 | 35                          | 0.11                             | 0.10                                   |
| PK1012-333K-□□ | 33000                    | 60        | 79.6kHz                | 0.19                 | 40                          | 0.10                             | 0.090                                  |
| PK1012-393K-□□ | 39000                    | 60        | 79.6kHz                | 0.17                 | 50                          | 0.090                            | 0.080                                  |
| PK1012-473K-□□ | 47000                    | 60        | 79.6kHz                | 0.15                 | 50                          | 0.080                            | 0.075                                  |
| PK1012-563K-□□ | 56000                    | 40        | 79.6kHz                | 0.13                 | 65                          | 0.075                            | 0.070                                  |
| PK1012-683K-□□ | 68000                    | 40        | 79.6kHz                | 0.12                 | 70                          | 0.070                            | 0.065                                  |
| PK1012-823K-□□ | 82000                    | 30        | 79.6kHz                | 0.10                 | 100                         | 0.060                            | 0.055                                  |
| PK1012-104K-□□ | 100000                   | 30        | 79.6kHz                | 0.10                 | 135                         | 0.055                            | 0.045                                  |

NOTE: Saturation Current(Isat) : the value of inductance decrease within 10%.

Temperature Rise Current(Irms) : Temperature rise of core surface within 20°C.

**● PK1018 series**

| Part No.       | L<br>@1kHz<br>(uH) | DCR<br>(Ω)<br>Max. | Saturation<br>Current<br>(A )Max. | Temperature<br>Rise Current<br>(A )Max. |
|----------------|--------------------|--------------------|-----------------------------------|---|
| PK1018-4R7K-□□ | 4.7                | 0.008              | 10.0                              | 6.0                                     |
| PK1018-6R8K-□□ | 6.8                | 0.011              | 8.0                               | 5.5                                     |
| PK1018-100K-□□ | 10                 | 0.017              | 7.0                               | 4.5                                     |
| PK1018-150K-□□ | 15                 | 0.022              | 5.5                               | 4.0                                     |
| PK1018-220K-□□ | 22                 | 0.026              | 4.5                               | 3.7                                     |
| PK1018-330K-□□ | 33                 | 0.032              | 3.8                               | 3.3                                     |
| PK1018-470K-□□ | 47                 | 0.035              | 3.2                               | 3.0                                     |
| PK1018-680K-□□ | 68                 | 0.047              | 2.6                               | 2.6                                     |
| PK1018-101K-□□ | 100                | 0.090              | 2.2                               | 2.0                                     |
| PK1018-151K-□□ | 150                | 0.129              | 1.8                               | 1.6                                     |
| PK1018-221K-□□ | 220                | 0.162              | 1.5                               | 1.5                                     |
| PK1018-331K-□□ | 330                | 0.212              | 1.2                               | 1.2                                     |
| PK1018-471K-□□ | 470                | 0.380              | 1.00                              | 1.0                                     |
| PK1018-681K-□□ | 680                | 0.548              | 0.84                              | 0.84                                    |
| PK1018-102K-□□ | 1000               | 0.844              | 0.66                              | 0.66                                    |
| PK1018-152K-□□ | 1500               | 1.18               | 0.55                              | 0.55                                    |
| PK1018-222K-□□ | 2200               | 2.00               | 0.46                              | 0.44                                    |
| PK1018-332K-□□ | 3300               | 2.53               | 0.38                              | 0.38                                    |
| PK1018-472K-□□ | 4700               | 3.19               | 0.32                              | 0.32                                    |
| PK1018-682K-□□ | 6800               | 5.69               | 0.26                              | 0.25                                    |
| PK1018-103K-□□ | 10000              | 7.30               | 0.22                              | 0.22                                    |
| PK1018-153K-□□ | 15000              | 10.5               | 0.18                              | 0.18                                    |
| PK1018-223K-□□ | 22000              | 21.8               | 0.14                              | 0.13                                    |
| PK1018-333K-□□ | 33000              | 25.7               | 0.12                              | 0.12                                    |
| PK1018-473K-□□ | 47000              | 36.1               | 0.10                              | 0.10                                    |
| PK1018-683K-□□ | 68000              | 57.3               | 0.08                              | 0.08                                    |
| PK1018-104K-□□ | 100000             | 89.7               | 0.06                              | 0.06                                    |

NOTE: Saturation Current(Isat) : the value of inductance decrease within 10%.  
 Temperature Rise Current(Irms) : Temperature rise of core surface within 20°C.



● **PK1213 series**

| Part No.       | L<br>@1kHz<br>(uH) | DCR<br>(Ω)<br>Max. | Saturation<br>Current<br>(A)Max. | Temperature<br>Rise Current<br>(A)Max. |
|----------------|--------------------|--------------------|----------------------------------|--|
| PK1213-100M-□□ | 10                 | 0.023              | 8.0                              | 5.1                                    |
| PK1213-150K-□□ | 15                 | 0.028              | 6.5                              | 4.5                                    |
| PK1213-220K-□□ | 22                 | 0.035              | 5.5                              | 4.2                                    |
| PK1213-330K-□□ | 33                 | 0.043              | 4.5                              | 3.7                                    |
| PK1213-470K-□□ | 47                 | 0.052              | 3.6                              | 3.4                                    |
| PK1213-680K-□□ | 68                 | 0.068              | 3.1                              | 3.0                                    |
| PK1213-101K-□□ | 100                | 0.097              | 2.6                              | 2.5                                    |
| PK1213-151K-□□ | 150                | 0.14               | 2.1                              | 2.1                                    |
| PK1213-221K-□□ | 220                | 0.20               | 1.7                              | 1.7                                    |
| PK1213-331K-□□ | 330                | 0.30               | 1.4                              | 1.4                                    |
| PK1213-471K-□□ | 470                | 0.43               | 1.10                             | 1.1                                    |
| PK1213-681K-□□ | 680                | 0.61               | 0.95                             | 0.99                                   |
| PK1213-102K-□□ | 1000               | 1.00               | 0.78                             | 0.78                                   |
| PK1213-152K-□□ | 1500               | 1.30               | 0.64                             | 0.68                                   |
| PK1213-222K-□□ | 2200               | 2.00               | 0.53                             | 0.55                                   |
| PK1213-332K-□□ | 3300               | 3.10               | 0.43                             | 0.44                                   |
| PK1213-472K-□□ | 4700               | 4.40               | 0.36                             | 0.37                                   |
| PK1213-682K-□□ | 6800               | 6.50               | 0.30                             | 0.30                                   |
| PK1213-103K-□□ | 10000              | 10.0               | 0.24                             | 0.24                                   |

NOTE: Saturation Current(Isat) : the value of inductance decrease within 10%.

Temperature Rise Current(Irms) : Temperature rise of core surface within 20°C.

\* Due to the limited space, the catalogue shows the typical specifications only. For more specific details ( characteristics graph, reliability, and others), kindly invite you to access 3L official website [www.3lcoil.com](http://www.3lcoil.com) for better known.