

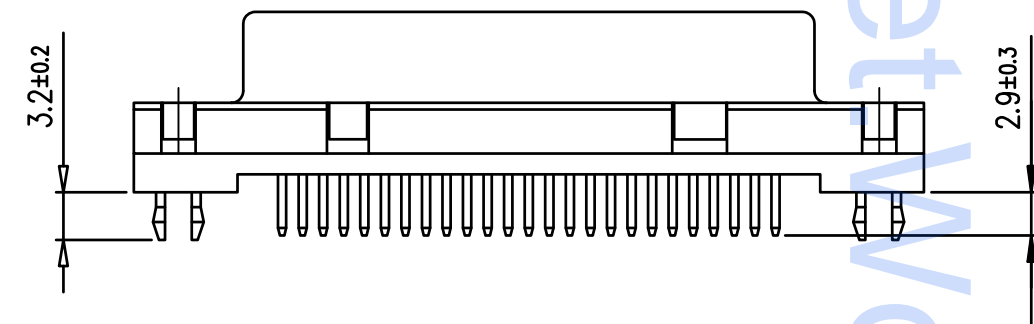

FCIconnect.com

Copyright FCI

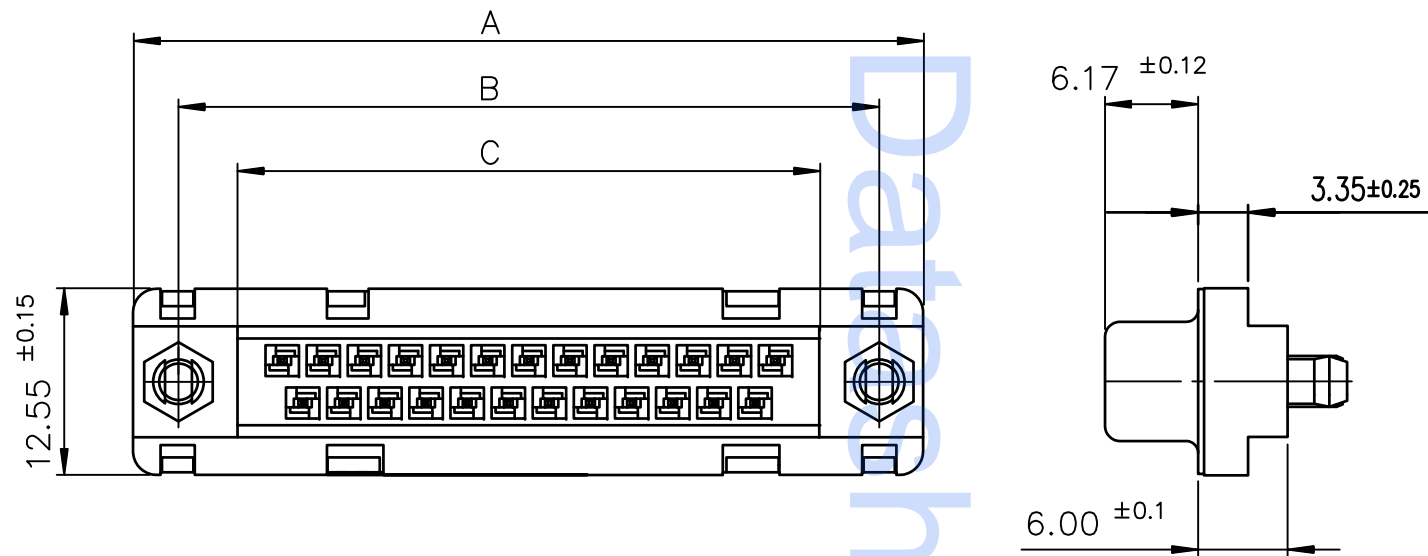

LEAD FREE PART NUMBER

SHELL	A±0.38	B±0.12	C±0.10	D±0.25	E±0.07	PART NUMBER
09	30.81	24.99	16.96	16.21	10.96	D09S24A.GL00LF
15	39.14	33.32	25.18	24.54	19.18	D15S24A.GL00LF
25	53.03	47.04	39.12	38.25	33.12	D25S24A.GL00LF
37	69.32	63.50	55.68	54.71	49.68	D37S24A.GL00LF

Plating: 4 --> Flash Au  
Plating: 6 --> 0.76µ Au

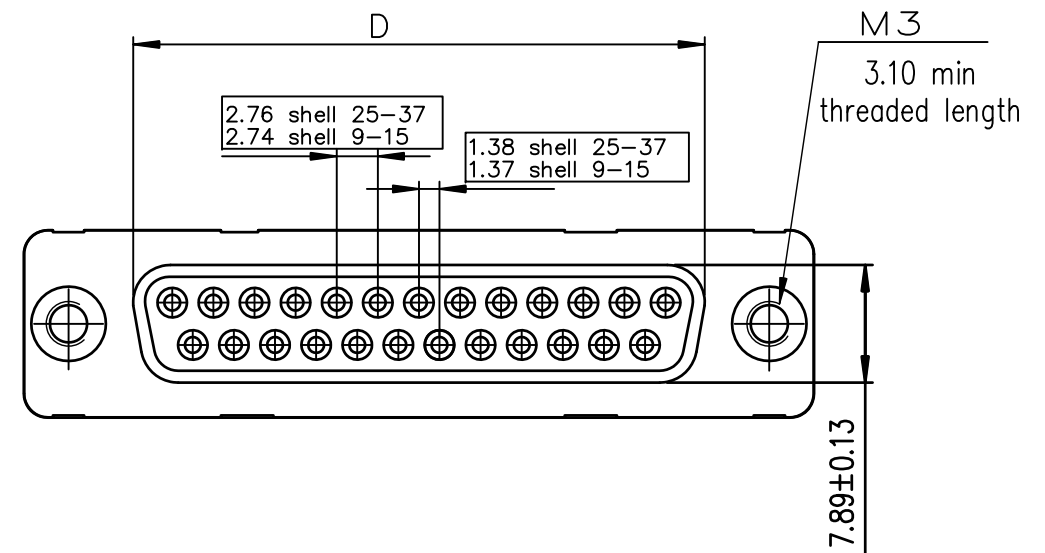

PC card drilling dimensions(after plating)  
(thickness 1.60±0.20mm)

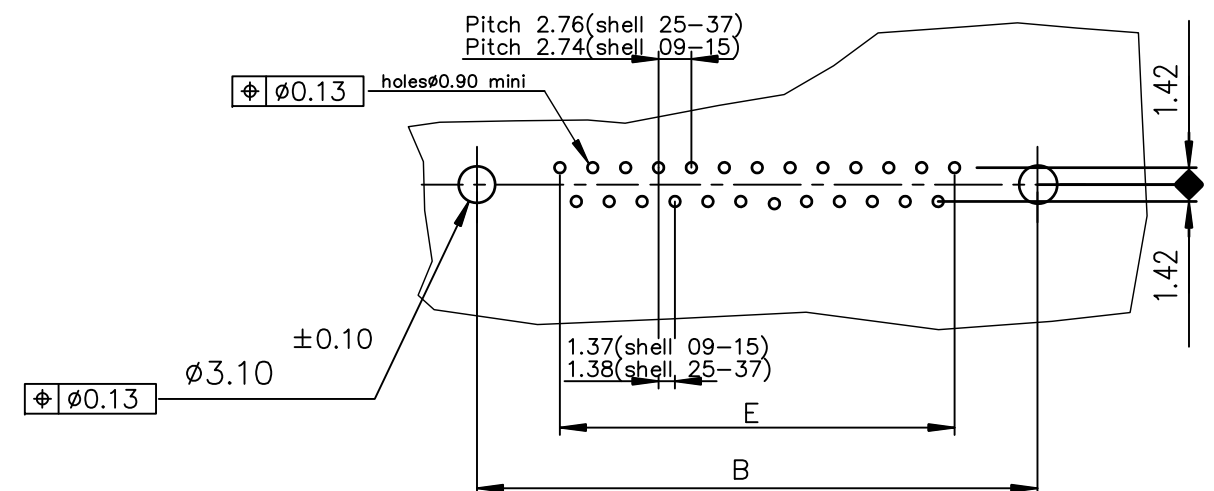

GENERAL CHARACTERISTICS AND ROHS INFORMATION:  
SEE DRAWING C01-8646-0000

mat'l. code				surface	tolerance	projection	product family			
-				ISO 1302	ISO 406 ISO 1101		D-SUB			
ltr	ecn no	dr	date	tolerances unless otherwise specified		MM	title			
H	ELX-I-21654	AB	2015-10-26	angles	linear					
				0°±2°			FEMALE DELTA-D STRAIGHT, SOLDER TYPE			
				dr	JOUBERT	1999-10-18	dwg no		sheet 1 of 1	size
				engr	ALIAS BABU	2015-10-26	C01-8646-0494			A3
				chr	MITHUN PAUL	2015-10-26	type Product Customer Drawing			
				appd	BIJU K PAUL	2015-10-26				
sheet index	revision sheet	H	1							